



Engineering progress  
Enhancing lives

## The Art of Storage

Storage solutions  
[interior.rehau.uk/tambourdoors](https://interior.rehau.uk/tambourdoors)



## Engineering progress

What drives the furniture industry? The continuous search for the perfect appearance, combined with the need for uncompromising reliability. Two standards which are deeply engrained in REHAU's DNA. This is the reason why we always scrutinise our existing products in order to turn something already good into something even better and simultaneously set new trends. In doing so, we always remain focused on the quality benchmark that has made us what we are today. In other words: Engineering progress. Enhancing lives.



**Enhancing lives**



A vertical photograph on the left side of the page shows a modern interior. In the foreground, a dark grey concrete pillar is partially visible. Behind it, a dark wood cabinet with a blue glass-effect door stands against a grey concrete wall. On top of the cabinet is a vase with dried branches and a small gold-colored geometric object. In the foreground, a cork stool with a black metal base is visible. The floor is a light grey concrete.

## Enabling creativity, creating favourite places.

Storage solutions to suit any taste, without compromising on functionality – that's the aim of our 'The Art of Storage' collection. Whether it's noble matt, glass-effect or metal tambour doors or a FLIPDOOR cabinet system – you can decide which storage solution is right for you.

Matching surfaces and edgebands in the coordination guide complete the product range.

# RAUVOLET tambour door and storage solutions

True to our motto 'Engineering progress. Enhancing lives.' we work on enriching your life and that of your customers just a little more with our well-thought-out innovations.

## 01 What we offer: Our materials & services



Whether it is high gloss or matt, metallic or simple and understated: we present you the available materials of our tambour door systems in this section.

### **The world of materials and surfaces**

Functionality meets design

Page 10



## Our services

In this section, we will present some of our current services to you:

### **Tambour door configurator**

Made-to-measure from a quantity of 1 Page 12

### **Customised printing**

Freedom in design Page 13

### **REHAU coordinated design**

An uncompromisingly harmonious and flawless appearance Page 14

## 02 What awaits you: Our product ranges

Discover the diversity of RAUVOLET solutions, their properties and advantages, as well as all the key information about colours, dimensions, etc.

### **Innovation instead of lack imagination**

FLIPDOOR Page 18

### **The allure of real glass**

RAUVOLET vetro-line Page 20

### **Smart glass in a tambour door**

RAUVOLET crystal-line Page 22

### **Elegance and functionality**

RAUVOLET noble matt Page 24

### **The classic**

RAUVOLET metallic-line Page 26

### **The flexible all-rounders**

RAUVOLET color-line and decor-line Page 28

### **Improved room acoustics**

RAUVOLET acoustic-line Page 29







# 01 What we offer

By constantly testing the limits of what is possible – coupled with an unerring instinct for trends, desires and requirements – we create solutions with the aspiration of enriching our lives. Discover our tailor-made services.

## **The world of materials and surfaces**

Functionality meets design

## **Configurators**

Made-to-measure from a quantity of 1

## **Customised printing**

Freedom in design

## **REHAU coordinated design**

An uncompromisingly harmonious and flawless appearance

# 01 The world of materials and surfaces



## Glass – modernity and airiness combined.

Elegance paired with perfection for light, glossy results.

When it comes to precious stones such as diamonds, quality matters. The cut is largely responsible for ensuring that the right amount of light enters the stone and is reflected. This results in the perfect interplay of light and shade.

Just as the facets make a diamond look attractive, glass surfaces and cuts also enhance pieces of furniture. The three storage solutions RAUVOLET vetro-line, RAUVOLET crystal-line and FLIPDOOR add a glossy look, but also modernity and airiness, to a room.



## Matt – a timeless feel, at any time.

Meeting demanding requirements for modern aesthetics and showcasing design features in eye-catching ways.

A matt finish is one of the major design trends. It captivates with its subtle elegance.

The matt surfaces in the RAUVOLET noble matt, crystal-line and FLIPDOOR product lines make luxury design more suitable for everyday use than ever before. They have unique tactile characteristics, a wide range of colours for all design features, while still requiring particularly little maintenance. We use innovative technologies to achieve this and draw on many years of experience as a system provider.



## Metal – fits any design.

Characterful surface combined with durability.

Metal has become an integral part of modern interior design and can be found in more and more homes. Metallic surfaces are not only visually striking, but also very durable and functional, making them an attractive choice for spaces where these properties are in particular demand, such as in kitchens, shops or the medical sector.

The RAUVOLET metallic-line can be perfectly combined with wood shades, stone effects, glass or matt surfaces, creating unlimited design combinations.



## The classics – durable and individual.

Natural vibrancy and impressive colour schemes – inspired by nature, refined with individuality.

Bringing nature indoors remains an ongoing trend – especially in kitchens that open onto the garden. Natural furnishings help us to forget the stress and hectic of everyday life.

This is exactly where RAUVOLET decor-line comes in, with its wide range of wooden decorative designs, such as birch, maple or cherry. Those who like a classic look can rely on RAUVOLET color-line. It is often a requirement in offices and shops, but also in the private sector to be able to adapt the tambour door to its surroundings.



# Made-to-measure configuration – from a quantity of 1

The innovative REHAU tambour door & FLIPDOOR configurator provides a wealth of creative design options.



You can configure storage systems for kitchens, bathrooms, offices or living spaces made-to measure - from a quantity of 1.



# More design freedom

The drive to create unique living spaces is one of the megatrends in our society.

With RAUVOLET customised printing, REHAU now enables home and business owners to print their own images and logos on their tambour door systems and integrate them into their existing interiors just the way they want.

- **Maximum design freedom** – that can be individually matched
- **Wide range of options** – thanks to our integrated image gallery
- **Smooth, quiet running** – thanks to REHAU component technology
- **Horizontal & vertical use** – to fit any space
- **Flexible installation** – thanks to different mechanisms and track systems
- **From a quantity of 1** – via the tambour door configurator

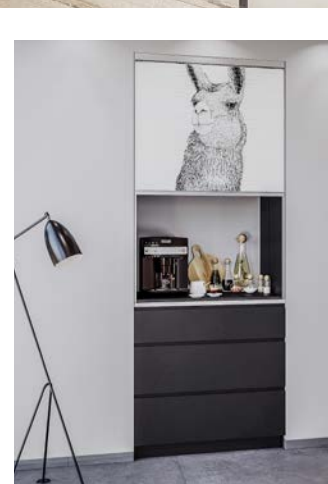

# Uncompromisingly harmonious: our product range coordination guide

Those, who value flawless results opt for REHAU, because our product range coordination guide ensures that surfaces, edgebands and storage solutions are perfectly matched in terms of appearance, tactile characteristics and materials.

This not only looks good, but also saves you time and energy – because you can get all components conveniently and reliably from one source. You can then focus on your real work: creating favourite places.









## 02 What awaits you

RAUVOLET tambour doors and FLIPDOOR offer you numerous ways to give your creativity free rein.

### Choose revolution, not evolution

FLIPDOOR

### The allure of real glass

RAUVOLET vetro line

### Smart glass in a tambour door

RAUVOLET crystal-line

### Elegance and functionality

RAUVOLET noble matt

### The classic

RAUVOLET metallic-line

### The flexible all-rounders

RAUVOLET color-line and decor-line

### Improved room acoustics

RAUVOLET acoustic line





**Choose revolution, not evolution:  
FLIPDOOR**

When you approach storage space as design in its own right, and go beyond mere functionality and conventional ideas, a simple overhead kitchen cabinet can be transformed into something completely new: FLIPDOOR.

The straight lines of the silhouette with 130 mm slats height – without visible track system – make a great first impression, but open FLIPDOOR cupboards are real eye-catcher, too. FLIPDOOR also offers outstanding practicality on every level: from its exceptionally smooth-running scissor movement via the space-saving opening mechanism through to the delivery of the complete cabinet.

**Coordinated  
design**

with RAUVISIO crystal



#### Available colours:

Carcass	Front	
<input type="checkbox"/> White 154726	<input type="checkbox"/> Bianco	matt 1696L* HGL V2778*
<input type="checkbox"/> Ivory 154727	<input type="checkbox"/> Perla	matt 1697L HGL V2892
<input type="checkbox"/> Silk grey 154728	<input type="checkbox"/> Nebbia	matt 1911L HGL 1910L
<input type="checkbox"/> Taupe grey 154729	<input type="checkbox"/> Titanio	matt 2109L* HGL 2107L
<input type="checkbox"/> Black 154730	<input type="checkbox"/> Piano	matt 2016L* HGL 2015L*

## Advantages of FLIPDOOR

- **Easy handling**  
due to smooth-running scissor movement
- **Flush closing**  
demonstrates high quality
- **Efficient use of space**  
due to space-saving opening mechanism
- **No abutting edges**  
for greater safety in everyday life
- **Ready for immediate use**  
FLIPDOOR is supplied fully assembled,  
including matching carcass



#### Customised via the configurator

Width: 600 mm, 900 mm or 1,000 mm  
Height: 650 mm or 780 mm  
Depth: 373 mm

Quick delivery programme\*  
Size: 900 x 780 x 373 mm

#### Cross-section of tambour door profile

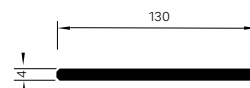



**The allure of real glass:  
RAUVOLET vetro-line**

## The innovative RAUVOLET vetro-line real glass tambour door system represents the highest level of interior design and brings the allure of glass indoors.

The sleek track system in aluminium, stainless steel or onyx black and slats made of sophisticated real glass, mounted flush to the vertical pelmet, make this glass tambour door cabinet the highlight of any room. With its 50 mm-wide slats made out of single-pane safety glass, RAUVOLET vetro-line achieves a harmonious, two-dimensional front. That's the secret of its impressive appearance, with the play of light creating a vibrant design experience in interior settings.

### Available colours:



satinato\*



black



white



smoke\*

## Advantages of RAUVOLET vetro-line

- **Colour-coordinated glass handle**  
ensures a harmonious overall effect
- **Sleek design**  
thanks to reduced width of the guide rail
- **Flush glass tambour doors**  
for an appealing interior design
- **Slats made of real glass**  
ensure a high-quality appearance along with high load-bearing stability
- **Easy to install**  
thanks to the 'plug & play' cassette solution



### Delivery options

Standard set dimensions  
600 x 1,000 mm  
600 x 1,500 mm  
900 x 1,000 mm  
900 x 1,500 mm

### Cross-section of tambour door profile



© by courtesy of Enex kitchen



\*with lateral dot matrix pattern

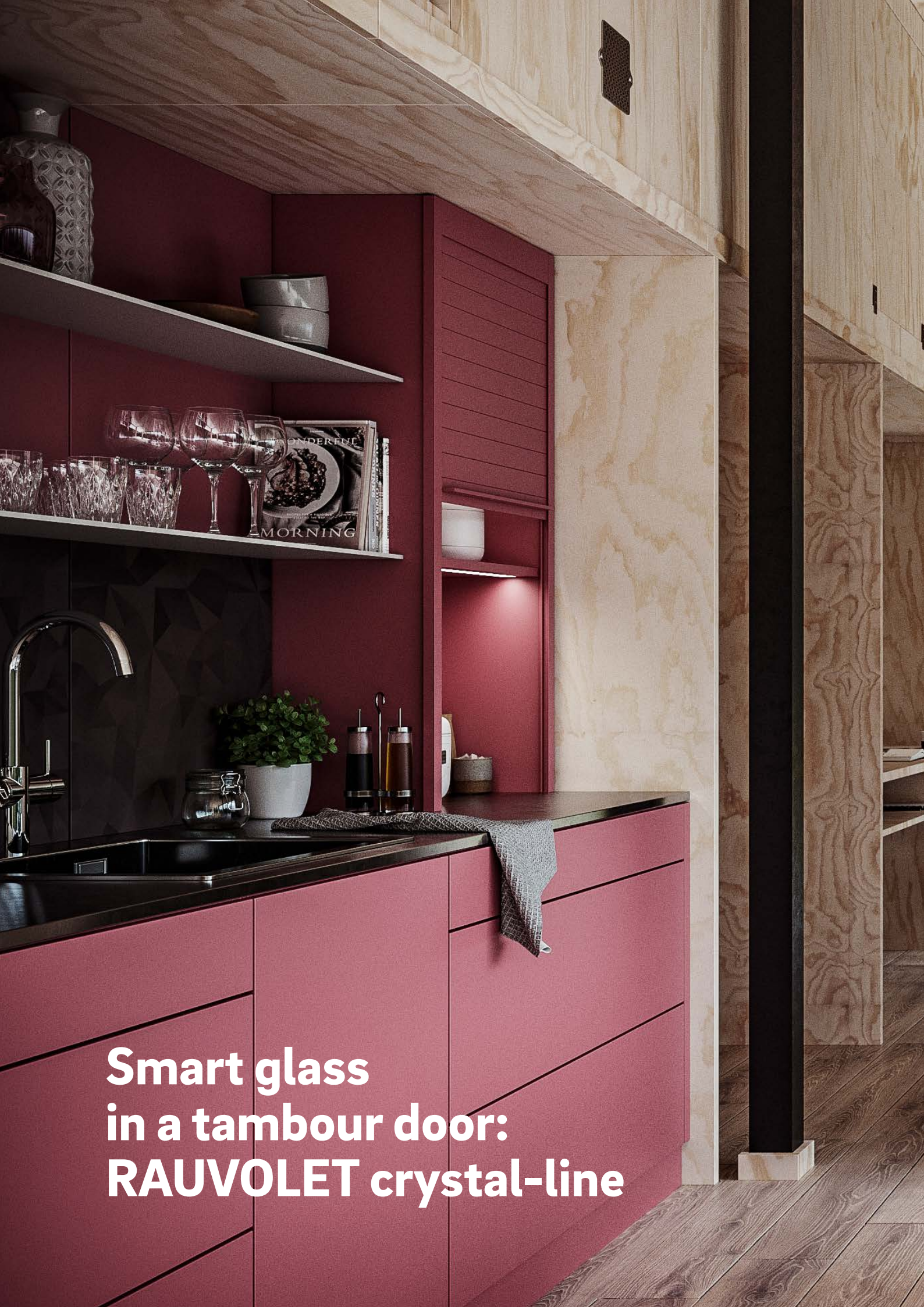

**Smart glass  
in a tambour door:  
RAUVOLET crystal-line**

# The RAUVOLET crystal-line tambour door system combines the aesthetic appeal of glass with all the benefits of a polymer tambour door system.

With 50 mm slats of polymer glass laminate, RAUVOLET crystal-line creates a harmonious, two-dimensional front panel that offers outstanding scratch resistance and breaking strength for everyday use. The track system is available as standard in aluminium, stainless steel or onyx black. The complete variant track system and vertical pelmet are available in RAUVISIO crystal for a colour and material match – ensures an optimal coordinated design.

### Available colours:



**Bianco**  
high-gloss V2778  
matt 1696L



**Magnolia**  
high-gloss 73703  
matt 1698L



**Piano**  
high-gloss 2015L  
matt 2016L



**Titanio**  
matt 2109L



**Oro Bianco**  
matt 2587L



**Luminoso**  
matt 2586L



**Aureo**  
matt 2578L



**Opale**  
matt 2588L



**Galassia**  
matt 2584L



**Basalto**  
matt 2585L

## Advantages of RAUVOLET crystal-line

- **50 mm slats**  
bring a sense of calm to the overall appearance
- **3 colour options in the accessory set**  
ensure a harmonious overall effect
- **Easy to install**  
thanks to the 'plug & play' cassette solution
- **Seamless appearance**  
thanks to RAUVISIO crystal accessory set (complete variant)
- **The right colour for every project**  
thanks to freely selectable RAL colour (RAUVISIO crystal vario\* on request)

\* see sample colours p. 22



### Delivery options

Standard sets for 16 mm and 19 mm panel thickness in the following dimensions:  
600 x 1,000 mm  
600 x 1,500 mm  
900 x 1,000 mm  
900 x 1,500 mm

### Cross-section of tambour door profile

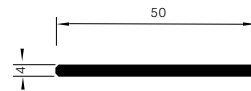

**Coordinated design**

with RAUVISIO crystal



# Elegant and functional storage: RAUVOLET noble matt





# A matt finish is one of the biggest design trends. It captivates with its subtle elegance.

RAUVOLET noble matt makes luxury designs more suitable for everyday use than ever before. Easy to use, it ensures maximum use of the available storage space and merges seamlessly with the front when closed – without a break in material or colour. The tambour doors coordinate perfectly with our noble matt RAUVISIO noir and RAUVISIO brilliant noble matt fronts.

### Available colours:



**Maltese Mist**  
Tambour door V3608  
Surface noir & brilliant noble matt 2463L



**Casa Blanca**  
Tambour door V3552  
Surface noir & brilliant noble matt 2453L



**High Low**  
Tambour door V3612  
Surface noir & brilliant noble matt 2454L



**Capital Starlit**  
Tambour door V3611  
Surface noir & brilliant noble matt 2455L



**Boxcar Blonde**  
Tambour door V3610  
Surface noir & brilliant noble matt 2464L



**Silver Lake**  
Tambour door V3553  
Surface noir & brilliant noble matt 2456L



**Smoke Stack**  
Tambour door V3613  
Surface noir & brilliant noble matt 2457L



**Trench Coat**  
Tambour door V3609  
Surface noir & brilliant noble matt 2458L



**Gaslit Alley**  
Tambour door V3554  
Surface noir & brilliant noble matt 2459L



**Olive Detour**  
Tambour door V3556  
Surface noir & brilliant noble matt 2460L



**Midnight Dash**  
Tambour door V3600  
Surface noir & brilliant noble matt 2462L



**After Dark**  
Tambour door V3555  
Surface noir & brilliant noble matt 2461L

## Advantages of RAUVOLET noble matt

- **High scratch resistance**  
to withstand everyday life
- **Anti-fingerprint and soft-touch functionality**  
prevents unsightly marks and is pleasant to the touch
- **Pleasant to use**  
thanks to easy running
- **Easy to install**  
thanks to the 'plug & play' cassette solution
- **Seamless appearance**  
thanks to matching accessory set

**Coordinated design**  
with RAUVISIO noble matt surfaces



### Delivery options

Standard sets for 16 mm and 19 mm board thickness in the following dimensions:  
600 x 1,500 mm  
900 x 1,500 mm

Customised via the configurator

Modular construction system: create your matching horizontal or vertical tambour door system from our standard stock range

### Cross-section of tambour door profile

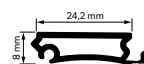

**The classic:  
RAUVOLET metallic-line**



# The high-quality metal effect of aluminium or stainless steel combined with the functional characteristics of polymer tambour door systems.

Available as 20 mm or 25 mm slats and a wide range of accessories, RAUVOLET metallic-line is an impressive option for creative interior design. Its timeless metallic look makes it the perfect match for a huge range of colours and decorative designs, and the wide choice of track systems, slam rails and slat widths gives you plenty of flexibility when planning your interior.

### Available colours:



Aluminium 230L



Brushed stainless steel 360L

## Advantages of RAUVOLET metallic-line

- **Attractive appearance**  
combination of real metal with a polymer tambour door system
- **Pleasant to touch**  
due to first-class fabrication
- **Smooth, quiet running**  
thanks to REHAU component technology
- **Versatile design**  
thanks to 20 mm and 25 mm slat widths
- **Easy to install**  
thanks to the 'plug & play' cassette solution



### Delivery options

Standard sets for 18 and 19 mm panel thickness in the following dimensions:  
600 x 1,000 mm  
600 x 1,500 mm  
900 x 1,000 mm  
900 x 1,500 mm

Made-to-measure via the configurator

Modular construction system: create your matching horizontal or tambour door system from our standard stock range

### Cross-section of tambour door profile variants

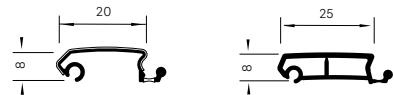

# The flexible all-rounders: RAUVOLET color-line/decor-line

When flexibility, adaptability and functionality are required.

With the RAUVOLET color-line and RAUVOLET decor-line tambour door systems, REHAU supplies two product ranges focused on maximum flexibility and adaptability, without compromising on user friendliness. With a choice of 10 decorative designs and colours, a variety of handles and built-in mechanisms and a wide range of different profile geometries, you are free to use the system any way you want.

## Available colours:



**Brilliant white** V3249 Only available as E9 profile

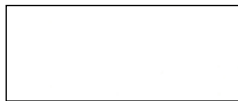

**Pure white** Similar to RAL 9010



**Grey** Similar to RAL 7035



**Anthracite grey** Similar to RAL 7016

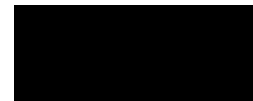

**Black** Similar to RAL 9011



**Aluminium decor** 7194



**Birch** 5514



**Maple** 7376



**Beech** 5018



**Cherry** 5429

## Advantages of RAUVOLET color-line/decor-line

- **Wide range of colour and design options**  
thanks to 10 different colours and decorative designs
- **Flexible installation**  
thanks to different mechanisms and track systems
- **Smooth, quiet running**  
thanks to REHAU component technology
- **Horizontal & vertical use**  
to fit any space



### Delivery options

Customised via the configurator.

Modular construction system: create your matching horizontal or vertical tambour door system from our standard stock range.

Various tambour door profiles available



# Undisturbed working: RAUVOLET acoustic-line

This patented tambour system transforms a simple cabinet into an effective sound insulator.

The tambour door system is the only one in its class that absorbs sound in a linear way across the entire frequency range – and it's especially effective in the range used for speech. In doing so, it shields office workers from irritating ambient noise. The RAUVOLET acoustic-line tambour door system combines the functional and design requirements you would expect from a modern office with highly effective sound insulation.

## Available colours:



Pure white RAL9010



Aluminium 7194

## Advantages of RAUVOLET acoustic-line

- **Highly effective sound insulation**  
across the whole frequency range
- **3 in 1**  
combines acoustic effectiveness with high-quality design and practical storage
- **High sound absorption rate**  
of  $\alpha_w = 0.7$
- **Sound absorption class B**  
(extremely absorbent)
- **Space-saving tambour door system**  
with up to 20% more efficient use of space
- **Can be ordered from a quantity of 1**  
via the tambour door configurator



### Delivery options

Made-to-measure via the configurator

### Cross-section of tambour door profile

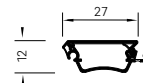

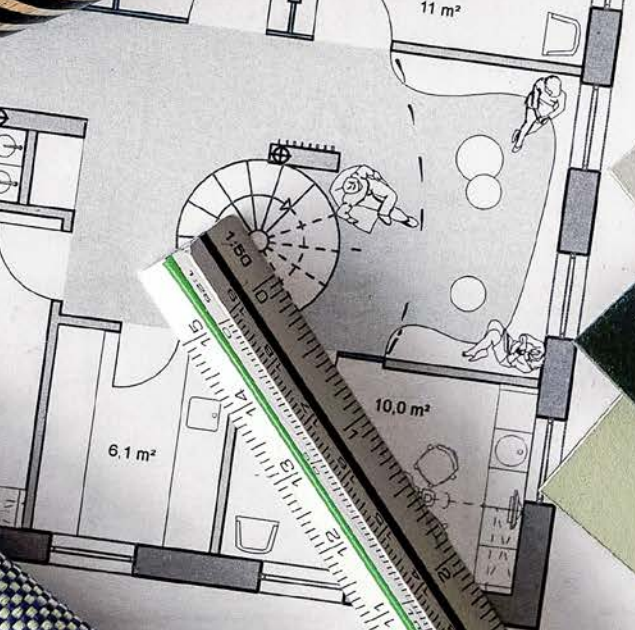

287  
297  
12.5  
12.5  
12.5



You are welcome to order  
free samples:  
[interior.rehau.uk/tambourdoors](https://interior.rehau.uk/tambourdoors)

**Do you have any questions about our products and services?  
We will be happy to help you:**

Ukinteriors@rehau.com  
interior.rehau.uk

© Photos: Getty Images  
p. 06: Bloomberg Creative Photos  
p. 08: svetikd / E+  
p. 10: top, large: Hoang Minh Dinh / EyeEm, small: Tomekbuđujedomek / Moment, bottom, large: Jenner Images / Moment, small: yuanyuan yan / Moment  
p. 12: skynesher / E+  
p. 30: Westend 61

p. 27, bottom, 28: in cooperation with Pixelbox and Kooplast

This document is protected by copyright. All rights based on this are reserved. No part of this publication may be translated, reproduced or transmitted in any form or by any similar means, electronic or mechanical, photocopying, recording or otherwise, or stored in a data retrieval system.

Our verbal and written advice with regard to usage is based on years of experience and standardised assumptions and is provided to the best of our knowledge. The intended use of REHAU products is described comprehensively in the technical product information. The latest version can be viewed at [www.rehau.com/TI](http://www.rehau.com/TI). We have no control over the application, use or

processing of the products. Responsibility for these activities therefore remains entirely with the respective user/processor. Where claims for liability nonetheless arise, they shall be governed exclusively according to our terms and conditions, available at [www.rehau.com/conditions](http://www.rehau.com/conditions), insofar as nothing else has been agreed upon with REHAU in writing. This shall also apply for all warranty claims, with the warranty applying to the consistent quality of our products in accordance with our specifications. Subject to technical changes.

[www.rehau.com/locations](http://www.rehau.com/locations)

© REHAU Limited  
Brinell Drive  
M44 5BL Irlam Manchester  
United Kingdom  
[interior.rehau.uk](mailto:interior.rehau.uk)  
[UKenquiries@REHAU.com](mailto:UKenquiries@REHAU.com)

B70707 GB-en 01.2023